

Landscape Design Assistance Program – Sample Base Map Instructions

To assist your Designer with the design consultation, we recommend that applicants draw a basic map of their property to scale on graph paper. Include existing fence lines, house location, plants/trees, and hardscape that will not change.

Using graph paper, draw a base map of your yard. The base map can include the following:

- An outline of the front of your home, walkways, driveway, sidewalk, property lines, fences, and other structures, indicating their placement on the property.
- Property orientation (a north arrow) in order to identify sun/shade patterns on your property.
- Draw the base map so that $\frac{1}{4}$ inch on the base map represents 1 foot in the real yard. Using the graph paper, use 1 square for every 1 foot.

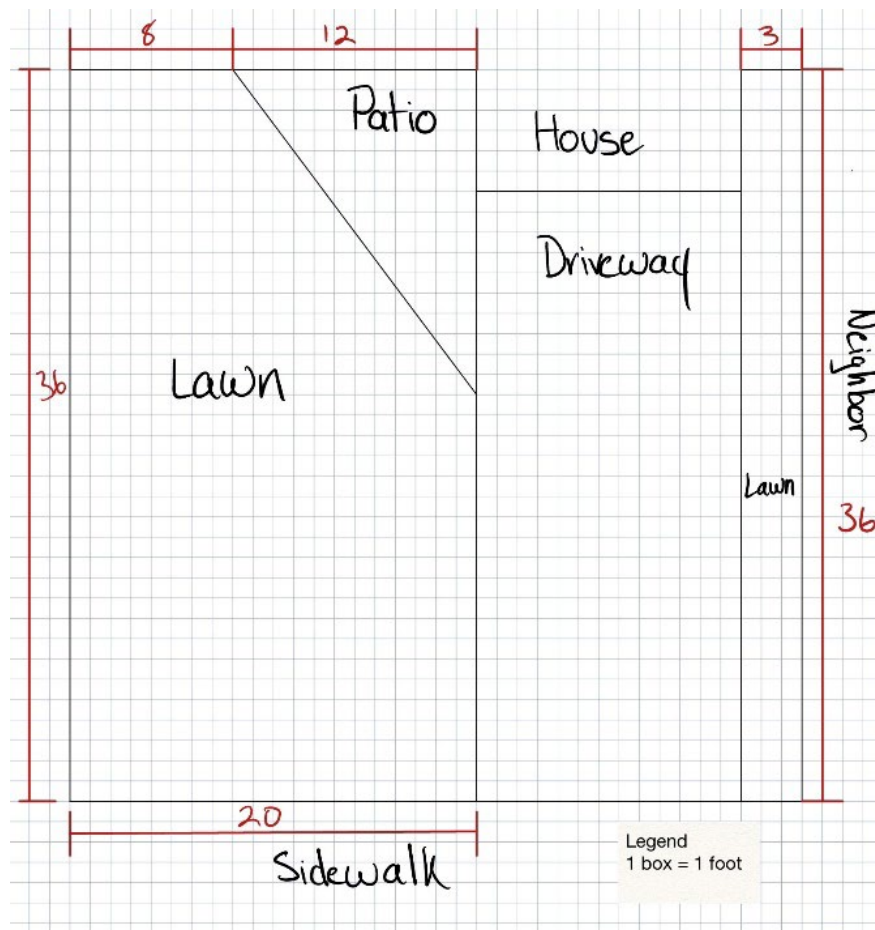

Alternatively, use GoogleMaps to create a base map:

1. Locate your property on maps.google.com
2. Click “Layers” at the bottom left of the screen and choose the “Satellite” view



3. Center your property on the map
4. Screenshot and print the base map in black and white, making sure to include the scale in the bottom right of the screen

